

Comprehensive services in project activities from the study to the project design, as-built documentation, including turnkey deliveries

EVERY PERIOD OF OUR BUSINESS IS A CHALLENGE FOR US

On behalf of our company, I would like to begin by wishing you good health, happiness, personal and professional success in the New Year 2021 and at the same time I would like to thank you for your goodwill in the past year and I hope in the New Year as well.

The year 2020 was marked by a slowing economy and uncertainties as the COVID-19 viral disease forced us to slow down and reflect on the impact of the pandemic on business. It was also important for our company to stabilise in these difficult times and to seek improvements and solutions at all levels of corporate governance. This newsletter is intended to be just a small part of what we want to bring to you. We would like to share our experience with you and gradually introduce you to our implementation team, which is an integral part of our work and a carrier of quality, innovation and a guarantor of the implementation of optimal solutions.

During its 23 years of existence, our company CHEMPROCES has built a stable market position in the field of industry, petrochemicals, food and renewable resources. Therefore, we have decided to briefly present our achievements in the individual industry segments.



Ing. Miroslav Tomšík
Managing director

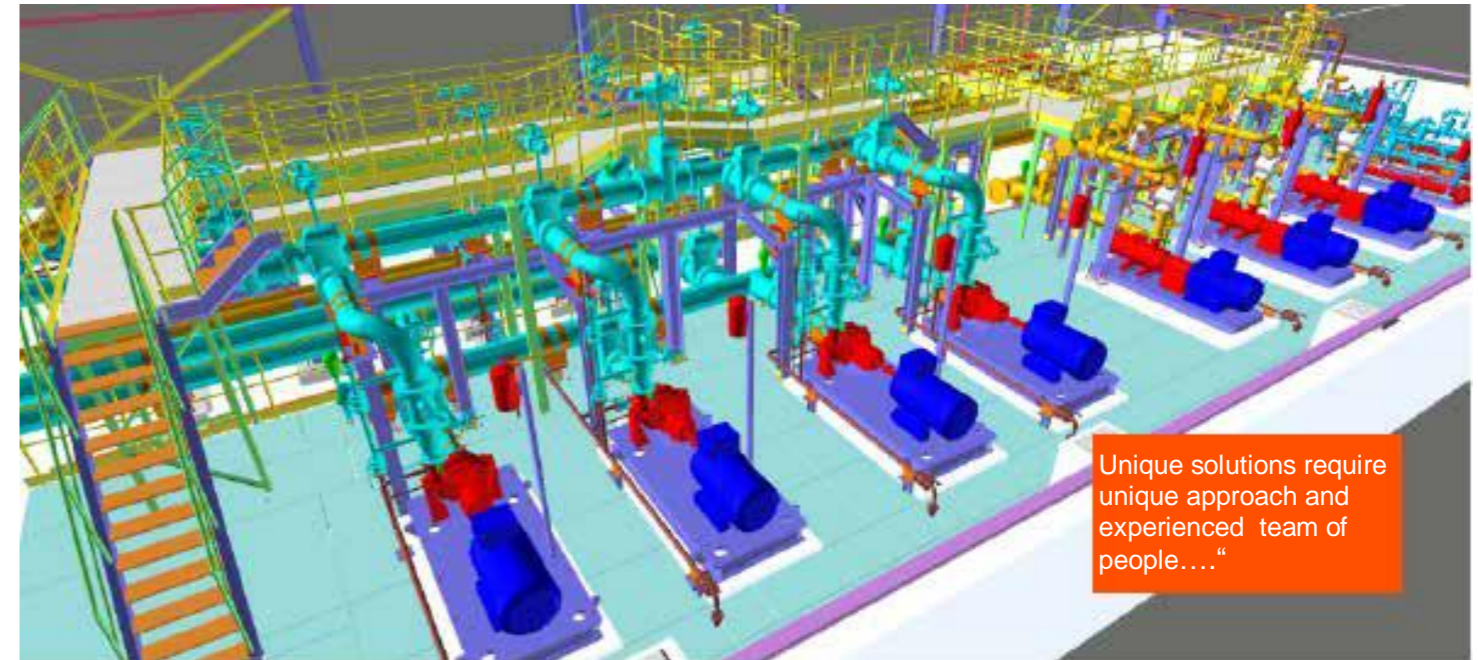

Unique solutions require unique approach and experienced team of people...."

Last year, we successfully completed and handed over the construction project "New Crude Oil Blending Station" for one of our largest clients. The project was a big challenge for us in terms of design, hydraulic network calculations, scope and volume of work. We carried out all stages of engineering activities from design for building permit, basic design, detail design, HAZOP, HSE, MC, approval, etc. The project also included the supply of 11 pumps, with a total installed capacity of more than 1 MW, for a new crude oil blending station located at the large capacity crude oil storage tank yard (90,000m³). We have created a unique solution for blending crude oil /Russian, alternative and slopes/, at the required output parameters, in order to further process the crude oil. The design of the main process equipment, such as pumps, was carried out according to the highest API standards for the petrochemical industry. After the test run and after the successful approval of the work, the investor can boast of an operation that is among the top in the whole EU.

Main pumps
RPHI S6 installed motor power
200 kW, 4 pcs

Auxiliary pumps
L3MG installed motor power
90 kW, 3 pcs

Auxiliary pumps
NM063 installed motor power
15 kW, 3 pcs



PROCESS MEDIA REGULATION IMPROVEMET IN VOLKSWAGEN BRATISLAVA

The production lines of the Bratislava car factory produce vehicles of world-class quality, which are constantly replenished during the production process with process media such as glycol, gasoline, diesel, AdBlue, ethanol and brake fluid. Since its inception, the production plant has grown continuously, resulting in the addition of new filling points in the halls. The original state of the filling station no longer matched the production capacity, which was reflected in more and more frequent line failures. These caused production and time losses during production, and cars often had to be moved off the lines and onto other sites.

Our company designed, optimised, supplied new filling technology and provided author supervision for the assembly in an extremely short time. The main benefit for our customer was the elimination of filling outages during production, increased reliability and reduced power consumption of the filling station..

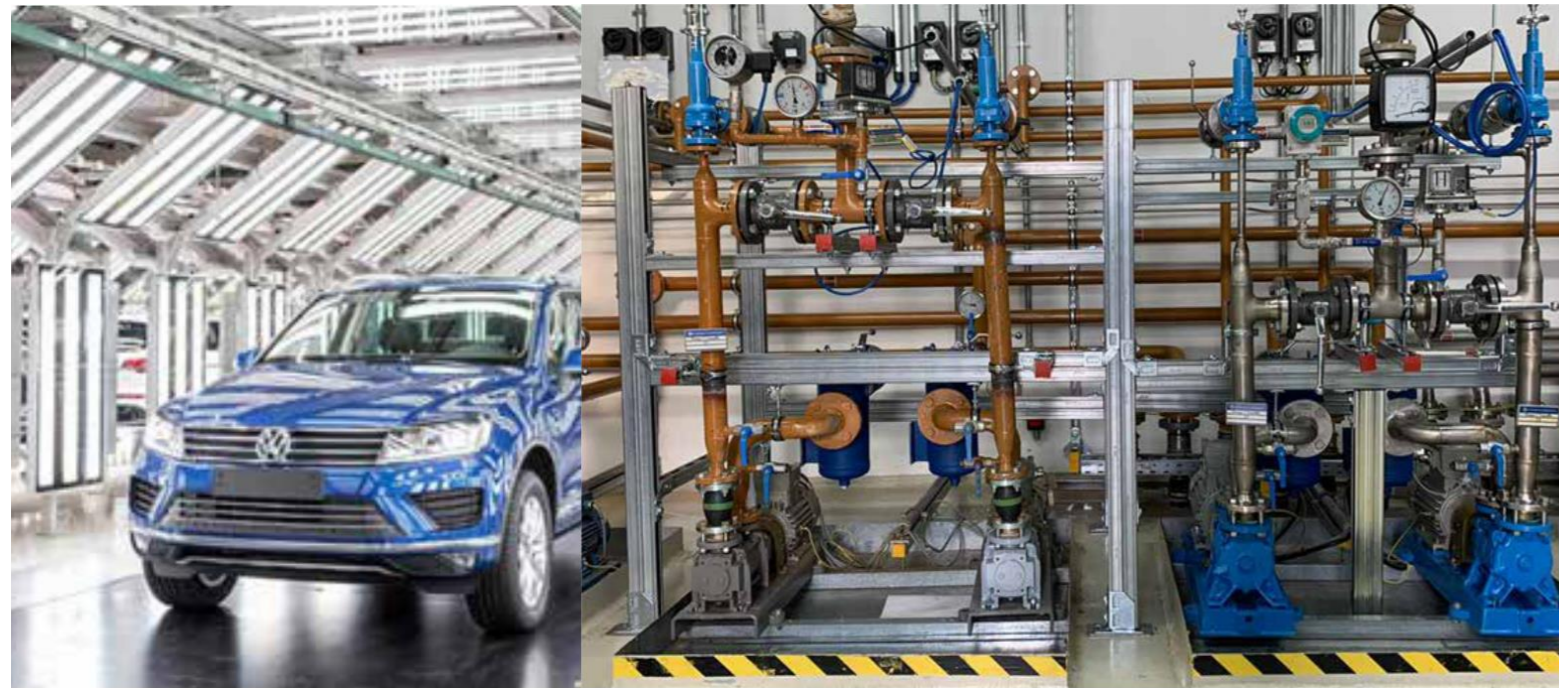

RECONSTRUCTION OF PUMP STATION AND REPLACEMENT OF WELL WATER PUMPS ON ZS6

Term of well water is not known to everyone. Crude oil in production contains, among other things, a high portion of water. As it is unsuitable for the environment and has no other use on the surface, it is pushed back to the oil reservoir. For our client, we have carried out all stages of project preparation, through the supply of the main process equipment /pumps, SECON-X double-wall safety piping, SGB continuous leak indication, fittings, Process Control and electrical/ to the commissioning of the pumping station.



MEDIUM :

ADBLUE
GLYCOL
BRZDOVÁ KVAPALINA
DIESEL
GASOLINE
ETHANOL

PRODUCTS :

2 x Magnetic coupling, self-priming pump CEHA1205
8 x Frequency inverter SINAMICS G120
4 x Flow meter SITRANS FVA250
10 x Self-priming pump AKH

Contact:

CHEMPROCES, spol. s r.o.
Šamorínska 52
SK - 821 06 Bratislava
Office secretary
tel : 02 / 4341 5221
web : www.chemproces.sk
e-mail : chemproces@chemproces.sk

